

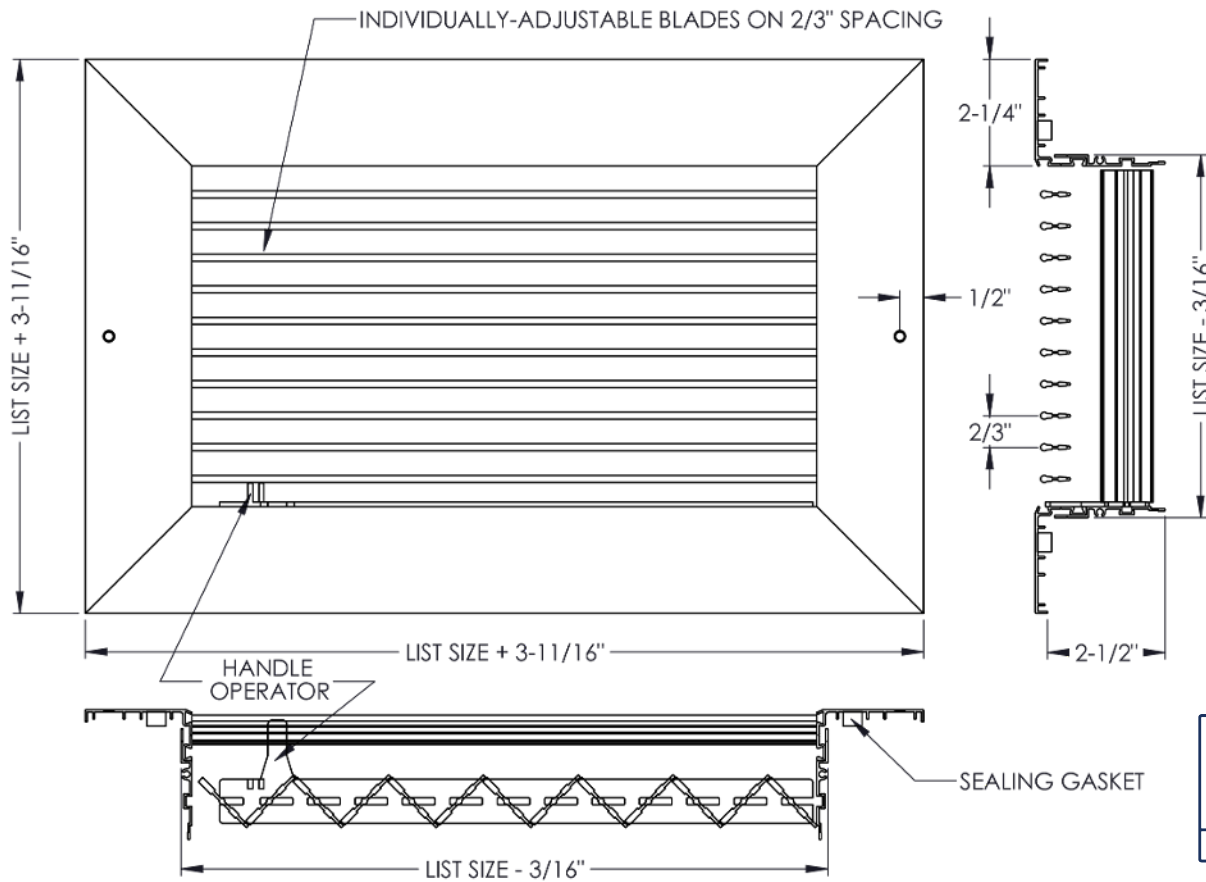

- Wide flange for additional surface coverage.
- Individually-adjustable horizontal blades with 2/3" spacing.
- Opposed blade damper with handle operator.
- Roll-formed aluminum blades with semi-airfoil design.
- Pressure-fit nylon pivot pins provide rattle-free performance.
- High-quality aluminum extruded frame.
- Sealing gasket used to prevent streaking on walls or ceiling.
- Countersunk #6 screw hole mounting c/w painted screws.
- Mullions used for sizes over 18" in length.
- Available with durable powder coat finish.



**3 DAY SHIP**  
ANY SIZE. ANY MODEL. GUARANTEED

**1. Specify Quantity**

\_\_\_\_\_

**2. Specify the Length x Height Dimensions**

Available on 2" increments as standard. Custom sizes down to 1/16" increments.

\_\_\_\_\_ x \_\_\_\_\_  inches  mm

**3. Select a Finish**

- W - White
- S - Silver

**4. Select a Lead Time**

- 3 Day Ship
- Next Friday
- Standard Delivery

**Additional Options**

- TB - No Screw Holes
- AA - All Aluminum

**Project / Location:**

**Architect:**

**Engineer:**

**Contractor:**



Scan for more product information.